

Application

Switch assemblies for command and control systems...

- Operating temperature: -55°C ... +85 °C.....with **H5459** or **H5463** Microswitches
-55°C ... +150 °C.....with **H5461** or **H5467** Microswitches
- 2 available contact configurations: up to 200 mA for low level applications or 4 A.
- 2 product types according to operating mode:
 - 2 maintained positions toggle switch,
 - momentary action for button or pushbutton switches
- Mechanical service life: 20 000 cycles.

Description

Manual control switches including snap-action switches.

- "H" type Microswitches ; 4 variants available :
 - **H5459** code : **59**
 - **H5461** code : **61**
 - **H5463** code : **63**
 - **H5467** code : **67**
- 1 to 4-poles.
- Panel mounting by way of M12 or M14 threaded bushing for sealed pushbutton.
- Fork terminals.
- Operating option:
 - toggle switch..... "**L**"
 - metallic round button "**P**"
 - plastic round button "**P**" + colour code
 - metallic sealed pushbutton "**PE**" + colour code

Electrical characteristics

See "H" types data for Microswitches assembled into manual control switches.

Ordering Details

Operating mode	Mounting bushing diameter	Microswitch type	P/N	Weight (1 piece) kg
Lever	M12	H5459	<input type="checkbox"/> 2L59	≤ 0.040
		H5461	<input type="checkbox"/> 2L61	
		H5463	<input type="checkbox"/> 2L63	
		H5467	<input type="checkbox"/> 2L67	
Metallic round button	M12	H5459	<input type="checkbox"/> 2P59	≤ 0.040
		H5461	<input type="checkbox"/> 2P61	
		H5463	<input type="checkbox"/> 2P63	
		H5467	<input type="checkbox"/> 2P67	
Plastic round button	M12	H5459	<input type="checkbox"/> 2P <input type="checkbox"/> 59	≤ 0.040
		H5461	<input type="checkbox"/> 2P <input type="checkbox"/> 61	
		H5463	<input type="checkbox"/> 2P <input type="checkbox"/> 63	
		H5467	<input type="checkbox"/> 2P <input type="checkbox"/> 67	
Metallic sealed pushbutton	M14	H5459	<input type="checkbox"/> 4PE <input type="checkbox"/> 59	≤ 0.055
		H5461	<input type="checkbox"/> 4PE <input type="checkbox"/> 61	
		H5463	<input type="checkbox"/> 4PE <input type="checkbox"/> 63	
		H5467	<input type="checkbox"/> 4PE <input type="checkbox"/> 67	

to be completed with bellow codes.



Coding (example)

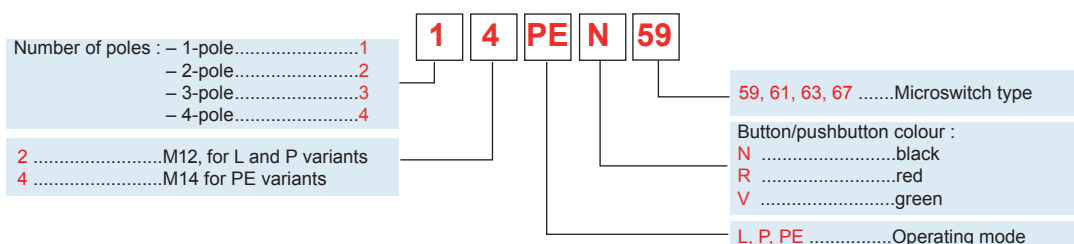

Circuit diagram

Connection

- 1 to 4-poles pushbutton switch

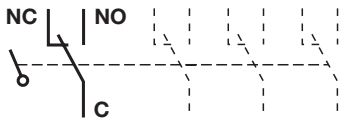

- 1 to 4-poles toggle switch

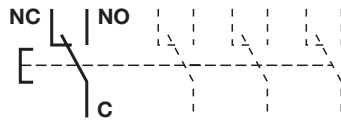

- "F" Fork terminals

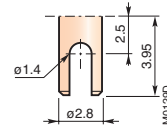

Dimensions

Toggle switch _2L...

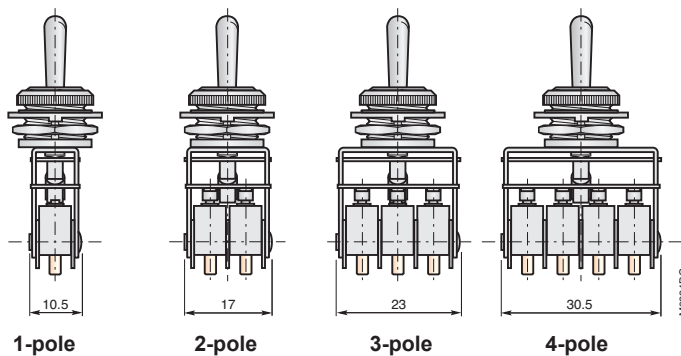
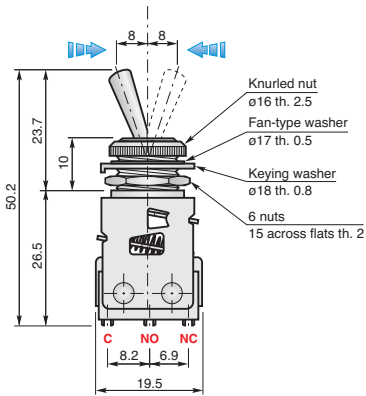

Panel hole detail

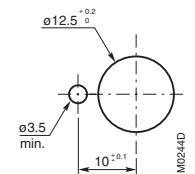

Thickness panel 3.5 max.

Pushbutton switch _2P...

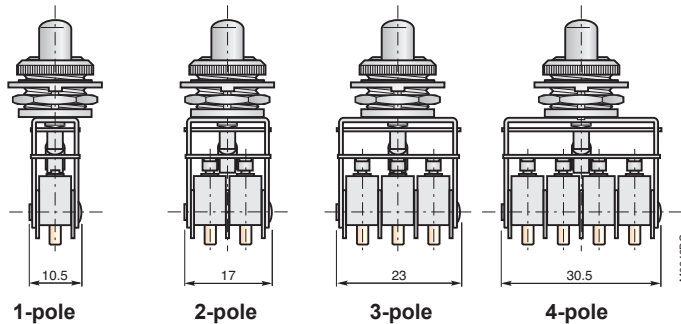
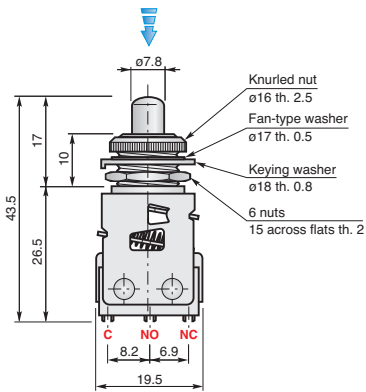

Panel hole detail

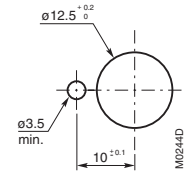

Thickness panel 3.5 max.

Sealed pushbutton switch _4PE...

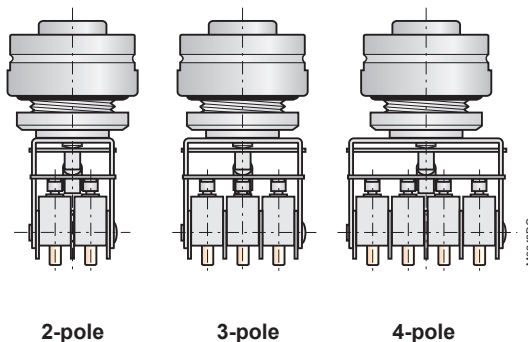
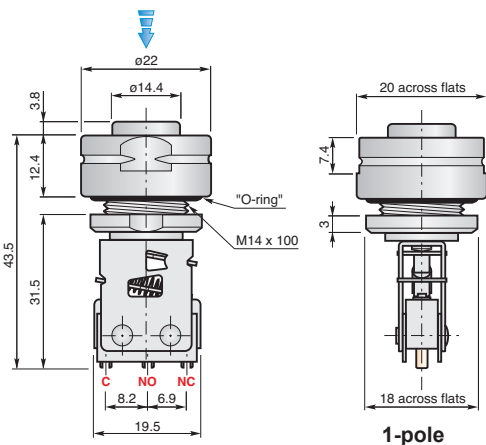

Panel hole detail

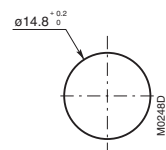

Thickness panel 2.5 max.